

Lynnwood Square

19800 44th Avenue W, Lynnwood, WA 98036



Property Highlights

191,277 Gross Leasable Area

18.00 Total Acres

343,753 5 Mile Population

- For additional updates and information visit www.NorthlineVillage.com.
- Property to be redeveloped and will be renamed Northline Village.
- Nearly 1,600 new apartments after full completion.
- 350,000 square feet of new office/ medical space that provides the latest technology integration, centered within a unique, amenity-rich environment.
- Over 80,000 square feet of new retail, restaurants, entertainment, and the new Village Green, will make this the ultimate gathering place for colleagues, friends, and families.
- Lynnwood Link light rail arriving in 2025.
- Please visit [this link](#) for the Northline Village Marketing Packet.

Demographics

	1-Mile	3-Mile	5-Mile
Population	19,679	140,140	343,753
Households	8,321	54,532	133,789
Avg HH Income	\$94,684	\$123,573	\$135,849

Source: Esri, 2023

Lynnwood Square

19800 44th Avenue W, Lynnwood, WA 98036

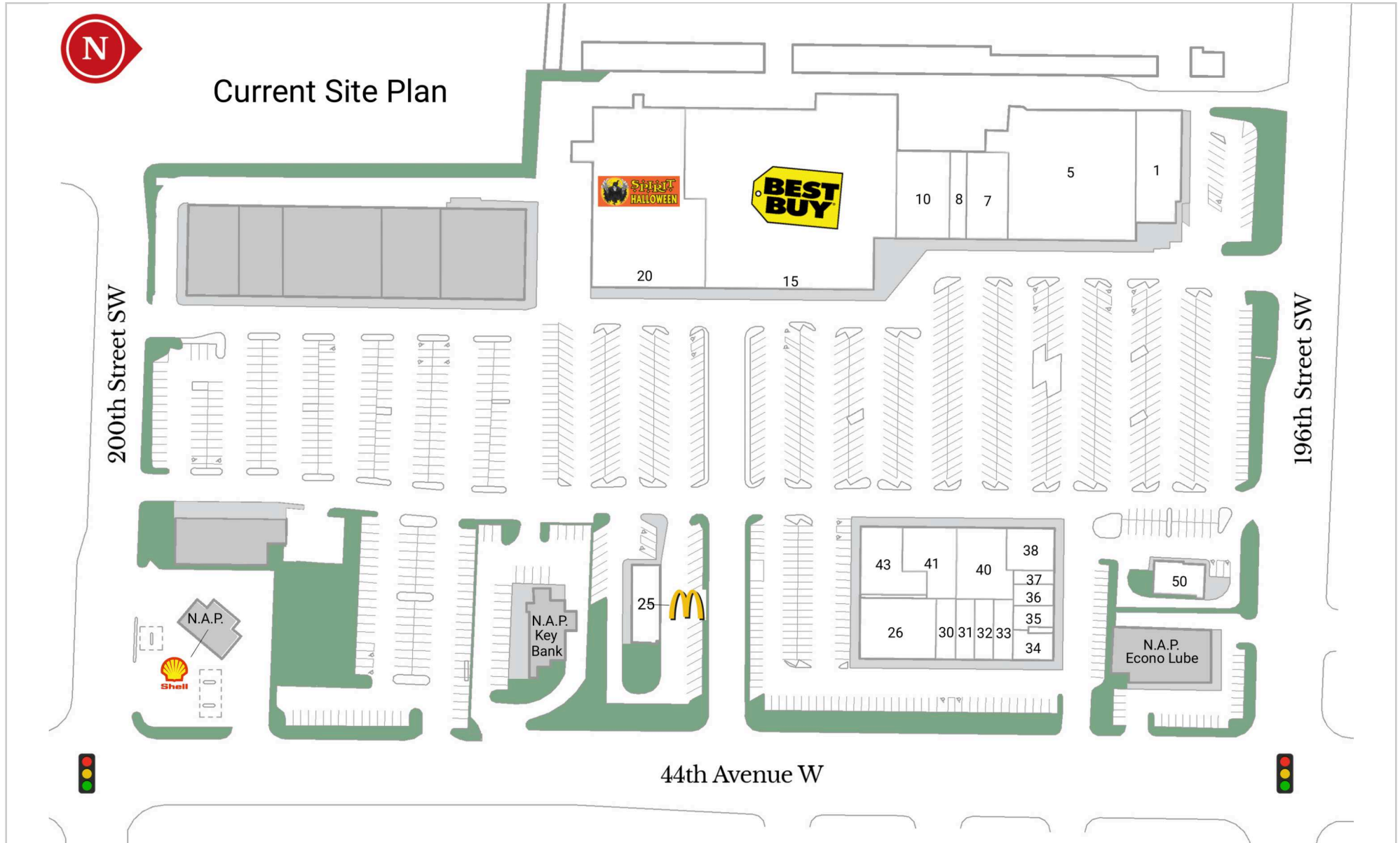

Lynnwood Square

19800 44th Avenue W, Lynnwood, WA 98036

Current Tenants

1	Elks Lodge	6,275 SF	32	Marshbank Construction	1,430 SF
5	Cheaper By The Day	20,536 SF	33	H&R Block	1,430 SF
7	Neosis	5,000 SF	34	Northern Lights	1,571 SF
8	Mongolian Grill	2,000 SF	35	Enjera Market	1,200 SF
10	Neosis	6,900 SF	36	La Vie Nails & Spa	1,144 SF
15	Best Buy	46,755 SF	37	Enjera Market	572 SF
20	Spirit Halloween	23,943 SF	38	Wild Wasabi Japanese Cuisine	2,206 SF
25	McDonald's	2,900 SF	40	Cheaper By The Day (Storage)	5,000 SF
26	Neosis Interiors	5,740 SF	41	Home Realty, Canyon Park, Inc.	4,600 SF
30	Cafe Kleo	1,430 SF	43	Pub 44	4,454 SF
31	Driving School	1,430 SF	50	Taco Time	2,256 SF