

Overlake East Center

15340 NE 24th Street, Redmond, WA 98052

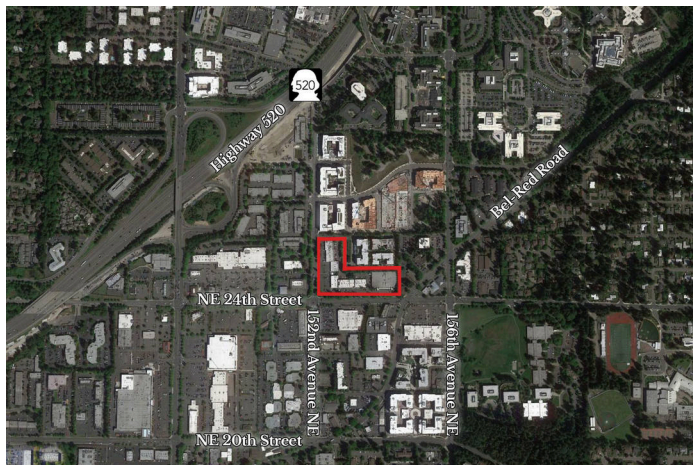
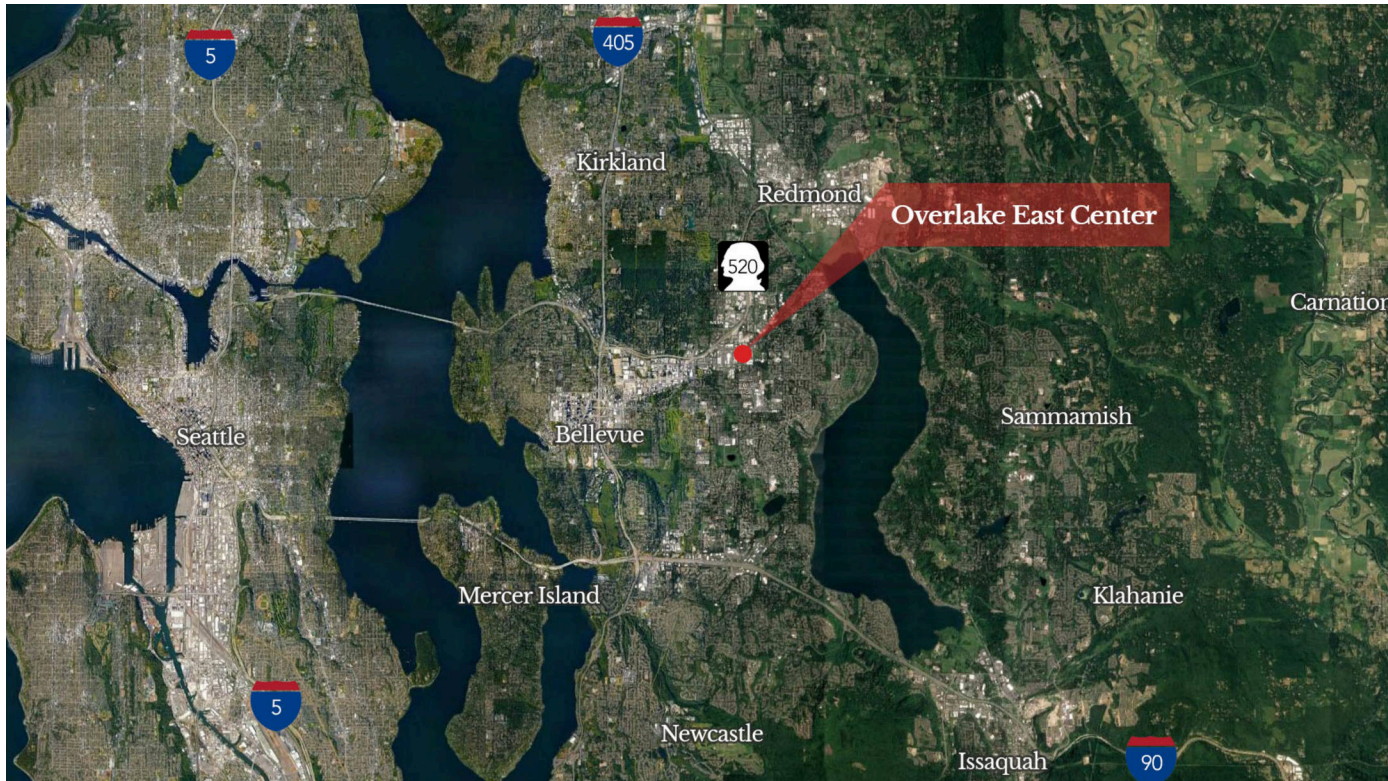

Property Highlights

90,325 Gross Leasable Area

6.12 Total Acres

256,294 5 Mile Population

- Average household incomes exceed \$150,000 within a 3-mile radius.
- Anchored by Macy's Furniture and Mayuri Foods.
- The property is a six-plus acre site in the Overlake Village area of Redmond, WA, located less than 1-mile from the Microsoft Headquarters employing 40,000 people in the area.
- The dense in-fill location will soon benefit from the new Sound Transit Link Light Rail Station under construction less than two blocks from the property that will create full connectivity set to open in 2023.

Demographics

	1-Mile	3-Mile	5-Mile
Population	22,061	106,058	256,294
Households	9,096	43,465	105,282
Avg HH Income	\$117,695	\$150,846	\$168,104

Source: Esri, 2019

Overlake East Center

15340 NE 24th Street, Redmond, WA 98052

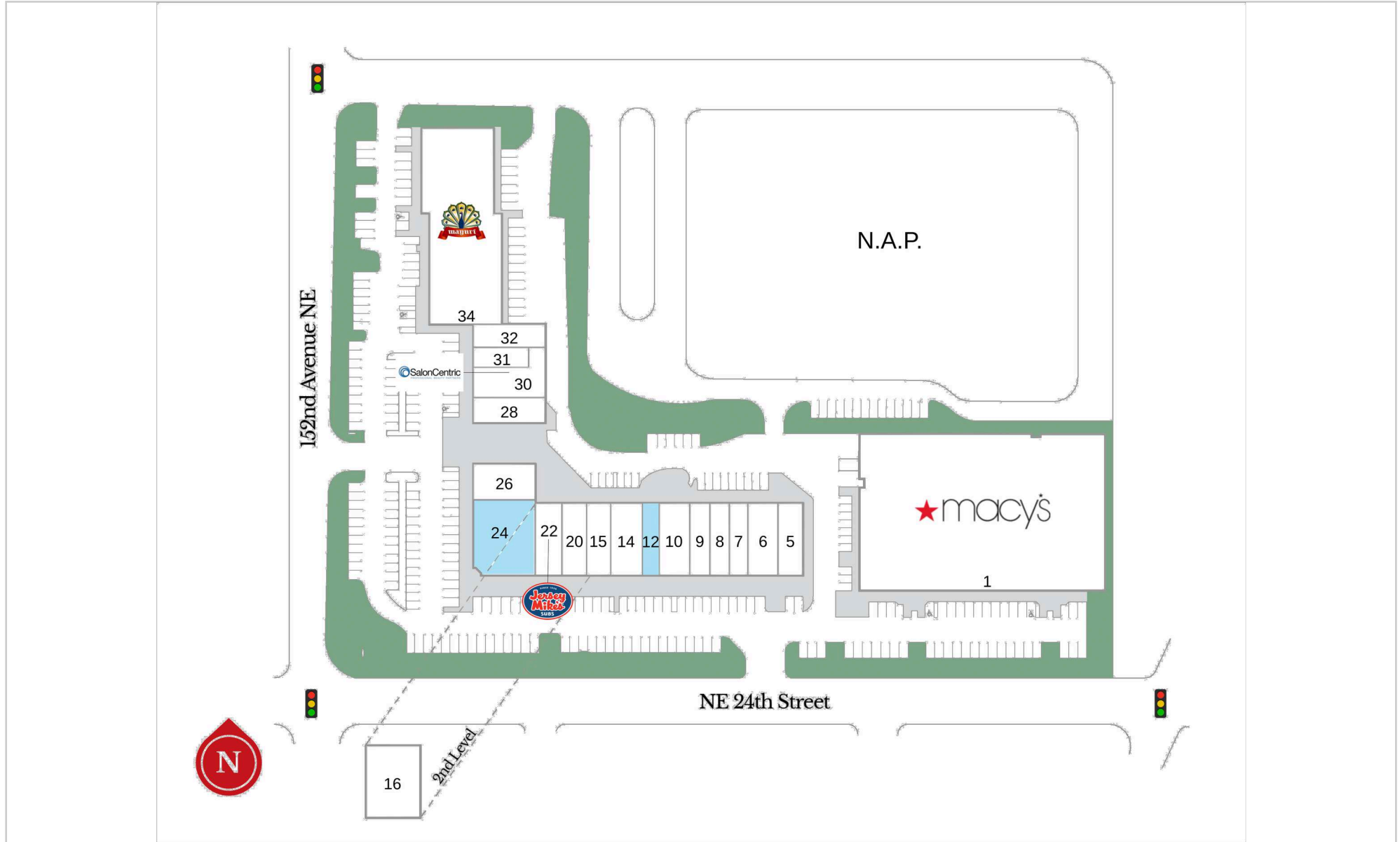

Overlake East Center

15340 NE 24st Street, Redmond, WA 98052

Current Tenants

1	Macy's Furniture Gallery	40,000 SF	16	Orient Entertainment	2,920 SF
5	Dynamic Chiropractic	1,875 SF	20	Teapot Vegetarian	1,875 SF
6	Overlake Tea Station	1,906 SF	22	Jersey Mike's Subs	1,875 SF
7	Overlake Eye Designs	1,500 SF	26	Kabab Palace	1,885 SF
8	Tian Tian Noodle	1,500 SF	28	Seoul Hot Pot	1,665 SF
9	Kiki Bakery	1,596 SF	30	Salon Centric	3,290 SF
10	Trudental	2,400 SF	31	Aapka Spa	874 SF
14	Malay Satay Hut	2,700 SF	32	Sapporo Teriyaki	1,500 SF
15	Mu Lan Foot Spa	1,787 SF	34	Mayuri Foods	15,000 SF

Available/Coming Soon

12	Available	1,352 SF
24	Available	5,525 SF